

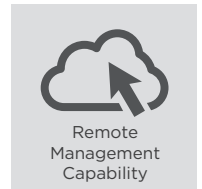

ADVANCED AND RELIABLE PFC UPS

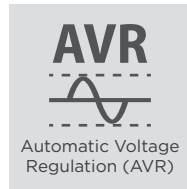
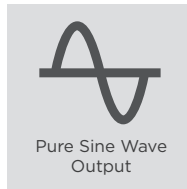
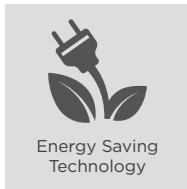
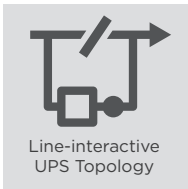

The active PFC compatible UPS with tiltable color LCD panel to provide intuitive power information

Designed for home, office and back office applications, the PFC Sinewave Series adopts line-interactive topology with Automatic Voltage Regulation (AVR) function to offer stabilized Pure Sine Wave output. The products are compatible with equipment requiring active PFC power supply. Other features include RJ45 port to provide data line protection as well as supply 1Gbps speed to transmit data, tiltable color LCD panel to display key information at a glance and power management software to achieve real-time monitoring and configuration.

SERIES FEATURES

- Line-interactive UPS Topology
- Energy Saving Technology
- Active PFC Compatible
- Pure Sine Wave Output
- Automatic Voltage Regulation (AVR)
- Color LCD Panel
- LED Status Indicator
- SNMP/HTTP Remote Management Capability (Optional)
- PowerPanel Management Software
- Surge and Spike Protection
- USB Charging Port(s)
- High-speed Ethernet Data Transmission
- Tower Form Factor

PRODUCT CALLOUTS

1. Power On Indicator
2. Power On/Off Switch
3. Function Button(s)
4. LCD Display Panel
5. USB Charging Ports
6. SNMP/HTTP Network Slot
7. Communication Protection Ports RJ45
8. Battery Backup & Surge Protected Outlets
9. Circuit Breaker
10. USB Port
11. Serial Port
12. AC Inlet

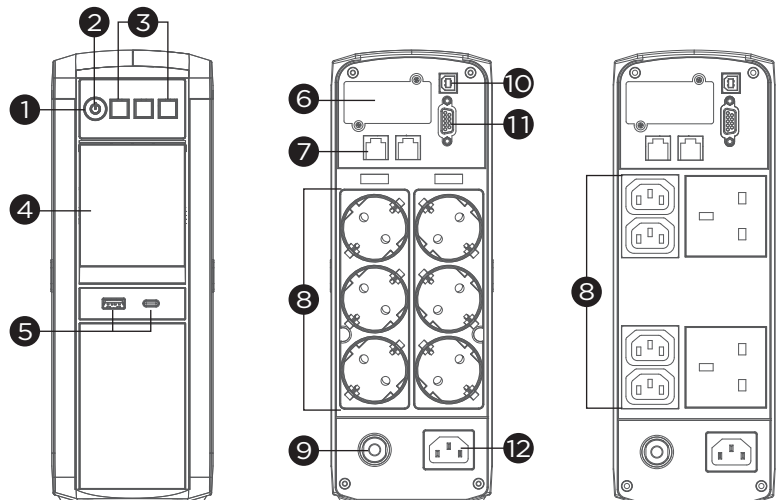

CP1350/1600EPFCLCD



TECHNICAL SPECIFICATIONS

Model Name	CP1350EPFCLCD	CP1600EPFCLCD
General		
UPS Topology	Line-interactive	
Energy Saving Technology	GreenPower UPS™ Bypass Technology	
Active PFC Compatibility	Yes	
Input		
Nominal Input Voltage (Vac)	220, 230, 240	
Input Voltage Range (Vac)	169 - 271	
Input Frequency (Hz)	50 ± 3, 60 ± 3	
Input Frequency Detection	Auto-sensing	
Rated Input Current (A)	10	
Input Connector Type	IEC C14	
Output		
Capacity (VA)	1350	1600
Capacity (Watts)	810	1000
On Battery Waveform	Pure Sine Wave	
On Battery Voltage(s) (Vac)	230 ± 5% (Under a test load of <60%. When the load >60%, the output voltage range may >5%.)	
On Battery Frequency (Hz)	50 ± 1%, 60 ± 1%	
Automatic Voltage Regulation (AVR)	Single Boost	
Overload Protection	Internal Current Limiting, Circuit Breaker	
Outlet(s) - Total	6	
Outlet Type	Schuko x 6 or UK x 2, IEC C13 x 4	
Outlet(s) - Battery & Surge Protected	6	
USB Charging Port(s)	USB-A x 1, USB-C x 1	
USB Charging Total Output	30 W	
USB-A Charging Output	5 V/ 2.4 A Max	
USB-C Charging Output	5 V/ 2.5 A Max, 9 V/ 2 A Max, 15 V/ 2 A Max	
Typical Transfer Time (ms)	8 (At normal sensitivity)	
Battery		
Runtime at Half Load (min)	9.6	9.7
Runtime at Full Load (min)	2.1	2.6
Typical Recharge Time (Hours)	8 (Recover to 90% after full load discharge)	
User-replaceable	Yes	
Battery Type	Sealed Lead-acid	
Replacement Battery Pack (RBP)	RBP0146	RBP0142
Replacement Battery Pack (RBP) Quantity (pcs)	1	
Surge Protection & Filtering		
Surge Suppression (Joules)	405	
Network Protection RJ45	1-in, 1-out	
Management & Communications		
LCD Panel	Yes	
LCD Types	Color LCD	
LED Indicators	Power On	
HID Compliant USB Port(s)	1	
Serial Port	Dry Contact	
Audible Alarms	Battery Mode, Low Battery, Overload, UPS Fault	
Power Management Software	PowerPanel Business (Recommended)	
SNMP/HTTP Remote Monitoring	Yes - with optional RMCARD205	
Physical		
Form Factor	Tower	
Physical Size - UPS Module		
Dimensions (WxHxD) (mm.)	100 x 280 x 355	
Weight (kg.)	10	11
Environmental		
Operating Temperature (°C)	0 - 40	
Operating Relative Humidity (Non-condensing) (%)	0 - 95	
Online Thermal Dissipation (BTU/hr)	19	24
Certifications		
Certifications*	CE	
RoHS	Yes	

*Certifications may vary according to different regions. Visit www.cyberpower.com for more information.
 #All specifications are subject to change without notice.